

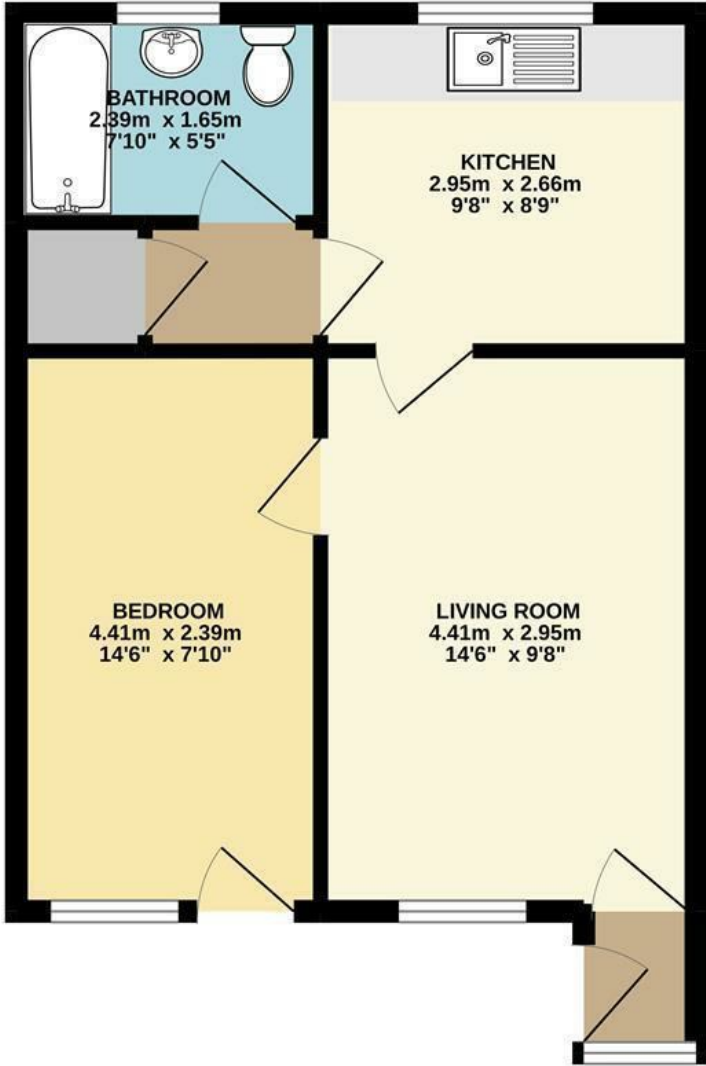

Yarmouth Road | Norwich | NR7  
 PCM £800 PCM

38.7 sq.m. (417 sq.ft.) approx.



TOTAL FLOOR AREA: 38.7 sq.m. (417 sq.ft.) approx.

Whilst every attempt has been made to ensure the accuracy of the floorplan contained here, measurements of doors, windows, rooms and any other items are approximate and no responsibility is taken for any error, omission or mis-statement. This plan is for illustrative purposes only and should be used as such by any prospective purchaser. The services, systems and appliances shown have not been tested and no guarantee as to their operability or efficiency can be given.  
 Made with Metropix ©2022

Energy Efficiency Rating		
	Current	Potential
Very energy efficient - lower running costs		
(92 plus) <b>A</b>		
(81-91) <b>B</b>		
(69-80) <b>C</b>		
(55-68) <b>D</b>		
(39-54) <b>E</b>		
(21-38) <b>F</b>		
(1-20) <b>G</b>		
Not energy efficient - higher running costs		
<b>England &amp; Wales</b>	EU Directive 2002/91/EC	

Disclaimer – In accordance with the Property Misdescriptions Act, the company gives notice that all descriptions, references to condition, necessary permissions for use and other details are given in good faith and believed to be correct, but any intending lessees do not rely on them as statements of fact, but must satisfy themselves by inspection or other means, as to their accuracy.

This spacious one bedroom Bungalow is located in the popular suburb of Thorpe St Andrew and offers a spacious lounge, fitted kitchen, bathroom, double bedroom and small garden area.

Thorpe St Andrew is situated to the east of Norwich and is serviced by numerous local amenities, including shops, schools, doctors and dentist surgeries. There are regular bus services into the city centre with Norwich train station providing daily services to Cambridge and London approximately 2 miles away.

